



## Yuasa Ficha Técnica

### Yuasa 12N5.5-3B - Convencional 12 Volt Batería

#### Rendimiento

Tensión	12
Capacidad (10-hour)	5.5Ah
Capacidad (20 horas)	5.8Ah
CCA @ -18°C	55A

#### Dimensiones (±2mm)

Largo	135mm
Ancho	60mm
Alto	130mm

#### Peso

Peso con Acido	2.5kg
Volumen de acido	0.4l

#### Tecnología

Tecnología	Placa Sb/Sb
Separadores	Reinforcing fiber+Glass Fiber



#### Esquema

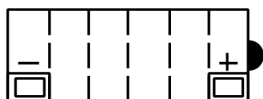

#### Tipo de terminal - 6

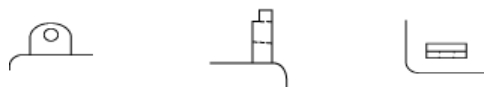

Fecha de emision: 27/10/2022 - E&EO



## Yuasa Technical Data Sheet

### Yuasa 12N5.5-3B - Conventional 12 Volt Battery

#### Performance

Voltage	12
Capacity (10-hour)	5.5Ah
Capacity (20-hour)	5.8Ah
CCA @ -18°C	55A

#### Dimensions (±2mm)

Length	135mm
Width	60mm
Height	130mm

#### Weights & Measures

Mean Weight with Acid	2.5kg
Acid Volume	0.4l

#### Technology

Technology	Cast Sb/Sb
Separator	Reinforcing fiber+Glass Fiber



#### Cell Assembly Layout

#### Terminal Type - 6

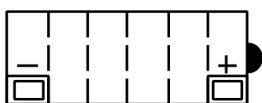

Data Sheet generated on 27/10/2022 - E&OE